

# Suction Accessories

## Suction Bottle Units

### Replacement Polycarbonate Bottles

#32-22-93-5001  
Bottle Only  
6/CS

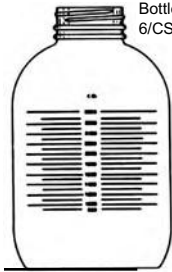

#32-22-93-5002  
Bottle Only  
6/CS



#32-22-93-5010  
Bottle 6/case



Suction units with caps

#32-22-104002 1/2 gallon (850cc)

#32-22-104003 1 gallon (2600cc.)

#32-22-104010 1 pint (trap)

### Models

### Cap & Float Assembly

#32-22-10-0008 The entire suction bottle cap & float assembly can be steamed or sterilized. A 1/4" I.D. patient port tube allows for high air displacement. There is a neoprene V-ring in the cap and float assembly which seals the bottle top.

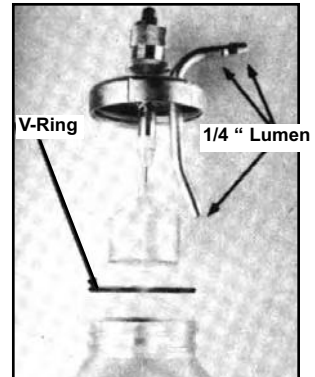
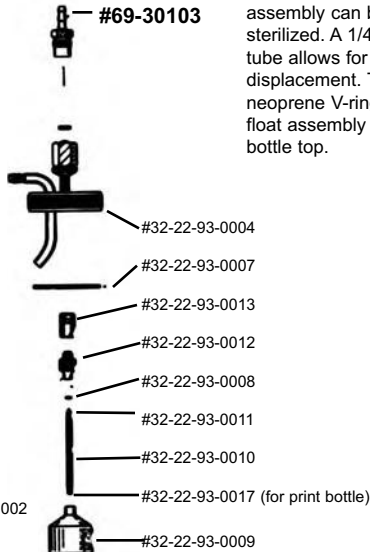

### Replacement Polycarbonate Bottles Autoclavable

#32-22-93-5001 1 Gallon plastic suction bottle 6/Box

#32-22-93-5002 1/2 Gallon plastic suction bottle 6/Box

#32-22-93-5010 1 Pint plastic suction bottle 12/Box

## Vacuum Bottle Holder Adapters

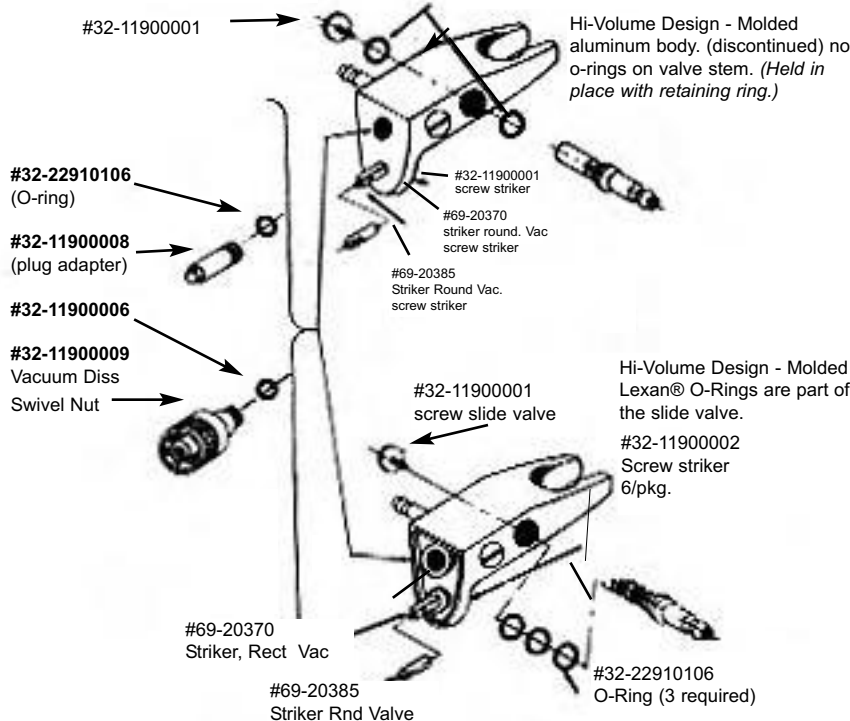

Hi-Volume Design - Molded aluminum body. (discontinued) no o-rings on valve stem. (Held in place with retaining ring.)

Hi-Volume Design - Molded Lexan® O-Rings are part of the slide valve.

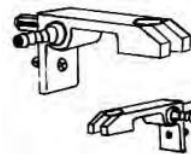

In early (1960) Vacuum Bottle Holder adapter, the lumen and drilling of the slide valve were designed to preclude air flow potential to the patient.

These older versions were identified under the following item #'s : 501632-63. 501644-63. 501628-63. 000304-63. 00302-63. 00303-63. 000305-63.

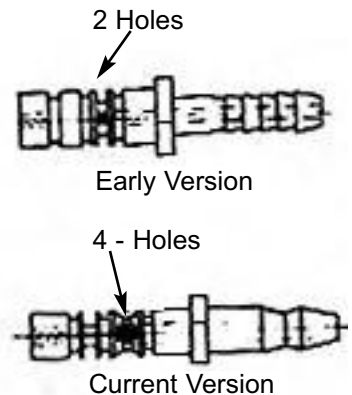

# Suction Accessories

## #EC-PM60-2 Roll Stand\*



The Roll Stand allows you to easily move a suction unit from room to room allowing (easy) placement anywhere. The stand's shelf is large enough to accommodate any of Precision Medical's air compressors, aspirators or nebulizer compressors.

The universal canister holder can accommodate numerous canister configurations.

\*All roll stands are sold without aspirators, Canisters or Vacuum Regulators.

## #EC-SCS2000 Suction Roll Stand\*



The SCS-2000 Model has a ball-pivot holder for attachment of the suction regulator. This allows movement of the regulator in any direction making visual observation of the suction rate easier. The four-port, on-off valve allows quick change from canister-to-canister during the suctioning process. The universal canister holder can accommodate numerous canister configurations.

\*All roll stands are sold without aspirators, Canisters or Vacuum Regulators.

## Patient Suction Tubing, Filter Assemblies & Hydrophobic Filter



Patient Suction Tubing comes in a 6' length.



Hydrophobic Filters provide airborne contaminant and overflow protection.



### Ordering Information

#EC-1690	Hydrophobic Filter (double ferrule connections)
#EC-502438	Hydrophobic Filter (one 1/8 NPT & one ferrule connection).
#EC-1955	Patient Suction Tubing (6 ft.)
#EC-502690	Inline Filter and Tubing Assembly (#EC-PM60-2)



### 800cc Canister shown

Canisters come in 3 sizes; 800cc, 1200cc and 2000cc. A self sealing lid provides a leak-free seal when vacuum is applied. An automatic float shut-off provides protection against canister overflow.

### #EC-PM9000 Vac Trap



#EC-PM9003 shown

The Vac Trap protects suction regulators and central vacuum systems from accidental contamination by liquid overflow from suction collection canisters.

This unique design assures positive shut-off at low as well as line vacuum conditions.

Various configurations are available for attachment to vacuum regulator or central vacuum system.

### Ordering Information

#EC-PM9000	Base Model (no fittings)
#EC-PM9001	Ohmeda Style Trap Bottle Connection
#EC-PM9002	D.I.S.S Hex
#EC-PM9003	D.I.S.S. Hand Tight
#EC-PM9004	D.I.S.S. Male
#EC-PM9005	90° Ohmeda
#EC-PM9006	90° Chemetron
#EC-PM9007	90° Puritan Bennett
#EC-PM9008	90° Oxequip

### Ordering Information

#EC-502519-10	800cc (Case of 10)
#EC-1906-12	1200cc (Case of 12)
#EC-502687-12	2000cc (Case of 12)

# Suction Accessories

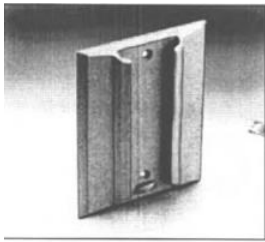

**#32-22-110006**

Bottle holder

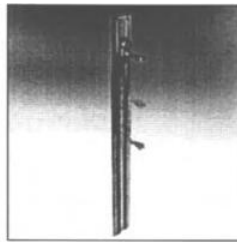

**#32-22-110005**

Anodized aluminum multi-level bottle bracket, 3 feet (.914 m) (does not include #32-22-110007).

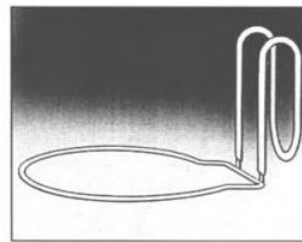

**#32-22-110024**

Suction bottle carrier for one-gallon (3.785 l) collection bottles. Carrier has four conductive swivel casters and a low center of gravity.

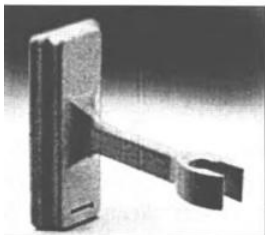

**#32-22-110004**

Bottle Holder Bracket

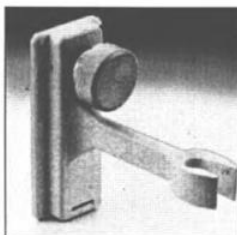

**#32-22-110007**

Bottle holder w/lock used with #32-22-110005 multi level bottle bracket.

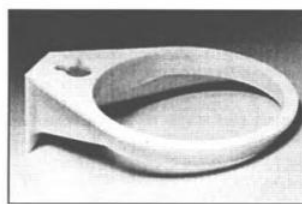

**#32-20020150**

Canister holder. Holds additional canisters by attaching to side brackets. (12 per carton).



**#69-20921**

DISS female to DISS male assembly is used between DISS outlet of suction regulator and Chemetron DISS inlet type disposable collection unit to allow replacement of DCU without the need to remove the suction regulator from the wall. Also serves to overcome space problems.



**#69-20328**  
Vacuum DISS Nut & Stem



**#69-20922**

DISS to Stem assembly. This DISS female to serrated stem assembly allows the user to mount a suction regulator on the "eye" hook of the #32-20-02-0002 floor mount holder. This permits use of the suction regulator on the operating room floor when stem inlet type disposable collection units are preferred.



**#32-20-02-0028**

Slide Brackett



**#32-20-02-0023**  
Collection Canister Carrier

Carries up to four Handi-Vak II collection canisters of either 1500 ml or 2400 ml size. Durable, chrome-plated steel construction that's easy to clean. No-sag, free-spinning, rotating casters. Comes with a DISS swivel-nut connection for connecting a suction regulator, a 1/4" barb fitting for attaching a vacuum hose, and 2 shut-off valves for regulating the suction to the canisters.



**#32-22-11-0002**

Suction Bottle Floor Carrier for one gallon collection bottle



**#32-22-11-0003**

Suction Stand to mount collection bottles and regulators